



## Venue & Technical Specifications

1. Address & Map Link
2. Contact Information
3. General Information, Stage & Power
4. Audio System
5. Audio (cont.) & Video System
6. Lighting Plot / House Patch
7. Regency Ballroom floorplan
8. Directions to Venue
9. Reserved Parking Map and Instructions
10. Parking Restrictions

### **Venue / Concert Address:**

The Regency Ballroom  
1300 Van Ness Avenue  
SF, CA 94109

### **Admin / Delivery Address:**

The Regency Center  
1290 Sutter St, 3rd Floor  
SF, CA 94109  
Delivery hours M-F, 9am-5pm

### **Stage Door:**

170 Fern Street (between Van Ness & Polk)  
SF, CA 94109

### **Map Link to Stage Door:**

<http://bit.ly/rballroom>

## Contact Information:

415-673-5176 Venue Phone  
415-292-9810 Main Fax

General Manager: Paul Billings  
415-345-0577 Phone  
415-292-9810 Fax  
[pbillings@aeqlive.com](mailto:pbillings@aeqlive.com)

Sales & Marketing: Bailey Nakano  
415-447-4900 Phone  
[bnakano@aeqlive.com](mailto:bnakano@aeqlive.com)

Production Manager: Justin Katz  
510-506-2210 Cell  
415-673-2160 Fax  
[justin@goldenvoice.com](mailto:justin@goldenvoice.com)

Operations Manager: Doug Elkins  
903-436-1280 Cell  
415-673-5937 Fax  
[delkins@aeqlive.com](mailto:delkins@aeqlive.com)

Audio Advance: Nate Harlow (Ultrasound)  
415-431-3523 Cell  
[soundprovider@earthlink.net](mailto:soundprovider@earthlink.net)

Lighting Director / Electrician: Andris Kasparovics  
415-606-3173 Cell  
[andris@heliogram.com](mailto:andris@heliogram.com)

Promoter: Goldenvoice  
1290 Sutter Street, Suite 206  
San Francisco, CA 94109  
415-777-1715 Phone  
[www.goldenvoice.com](http://www.goldenvoice.com)

Concert Booking: David Lefkowitz  
415-775-1715 Phone  
415-255-0220 Fax  
[david@goldenvoice.com](mailto:david@goldenvoice.com)

Concert Marketing: Joan Rosenberg  
415.563.3035 Office  
415.350.5966 Cell  
[joan@goldenvoice.com](mailto:joan@goldenvoice.com)

## General Information:

Capacity: 1424

Dressing Rooms: 4

Tour Production Office: 1 (WiFi only, no hard line or fax)

Backstage Bathrooms: 2

Showers: NO

Stage Barricade: Yes ("Mojo" type, blow-through)

Wi-Fi: Yes

Networks: "Goldenvoice Production" and "Grand Ballroom"

Password: 4158675309 (both networks)

## Stage Dimensions:

Proscenium: 30' Wide x 20' High

Stage: 30' Wide x 28' Deep x 24' High

Sound Wings: 10' Wide x 18' Deep

Total Stage Width: Down Stage = 54' Up Stage = 46'

Stage to Ceiling: 24'

Fly Bars: 3 midstage pipes, 1.5" pipe batton

Weight Capacity of pipes: 150 lbs each

Three (3) Truss: See Lighting Plot for equipment and rating

## Power:

### Lighting:

400Amp 3ph 5wire cam-lock, both straight and reversed G&N, SR

Dimmer located mezzanine SR

25' Feeder Required to reach stage floor

### Sound:

100Amp 3ph 5wire cam-lock, non-reversed G&N

Located stage level SR.

100Amp Sound Sub Panel on back wall SR corner.

### Onstage:

4- 120v 20A Edison

2- 120/208v 30A L14-30

1- 208v 20A L6-20

## Audio System Summary:

**The Regency Ballroom has a DAYTIME SOUND CURFEW OF 5:00PM (weekdays only). This means no noise before 5:00PM except per advance, no exceptions.**

**The Regency Ballroom has a 105db SPL LIMIT (A-Weighted) at all times. We are required by the City and County of San Francisco to meter and enforce this limit.**

### **Main PA (Left / Right + Subs):**

7x JBL VerTec VT4889 line array loudspeakers flown per side  
10x JBL VerTec VT4880 line array sub-bass loudspeakers floor, center block in mono  
Amplifiers: Crown Itech 6000 & Itech 8000  
Drive System & EQ: Lake Contour dsp Processor w/ laptop control surface  
2x JBL VP7212/95 powered loudspeakers per side – stacked front-fill  
(sub-bass may be run off an aux or fed from L/R)

### **Front of House:**

1x Yamaha PM5D-RH V2 digital mixing console  
1x Summit DCL200 dual channel tube compressor  
2x TC Reverb4000 efx processor  
1x TC DTwo digital delay line

### **Onstage Monitors**

**(12 mixes; 2x side-fills, 1x drum monitor, 9x floor mixes):**

1x Yamaha PM5D-RH V2 digital mixing console  
12 channels outboard 1/3 octave EQ  
2x Meyer MSL-4 + 2x Meyer HP600 sub-bass (side-fill monitors)  
2x Meyer MJF212 powered floor monitors + 1x HP600 sub-bass (drum monitor)  
10x Meyer MJF212 powered floor monitors

### **Microphones & Microphone Stands:**

2x Shure Beta 52  
6x Shure SM57  
4x Shure Beta 57  
8x Shure Beta 98D/S  
4x Shure KSM44/SL  
8x Shure SM58  
4x Sennheiser MD421  
6x Sennheiser MD609  
2x AKG 460 CK61  
4x Shure H-Band UHF-R handhelds with SM58 capsules  
18x tall AKG boom microphone stands  
10x small Atlas small boom microphone stands

### **Onstage Power:**

4x 30A edison circuits  
Camlock input available for tie-in – total power available for sound  
100A. / 3 phase

**Additional Audio Info:**

Snake, split, that monitor position Stage Left wing. Amp racks Stage Right wing.

54 channel snake, channels 49-54 turned around for return lines.

Split is passive with 1 female ramlatch split available in addition to the two splits for the house consoles.

**Video System:**

PROJECTOR: Sanyo XF60 6500 lumen projector flown on our FOH truss.

1.3 fixed lens focused to fill our 15x20 screen dead hung US. 1024x768 resolution, RGBHV input via BNC or VGA. Video run terminates SR with enough cabling to reach center stage.

We have adapters to accommodate standard VGA (PC & Mac), DVI (PC & Mac), Mini-DVI (Mac), Mini Display Port (Mac) only.

Sound Sub Panel

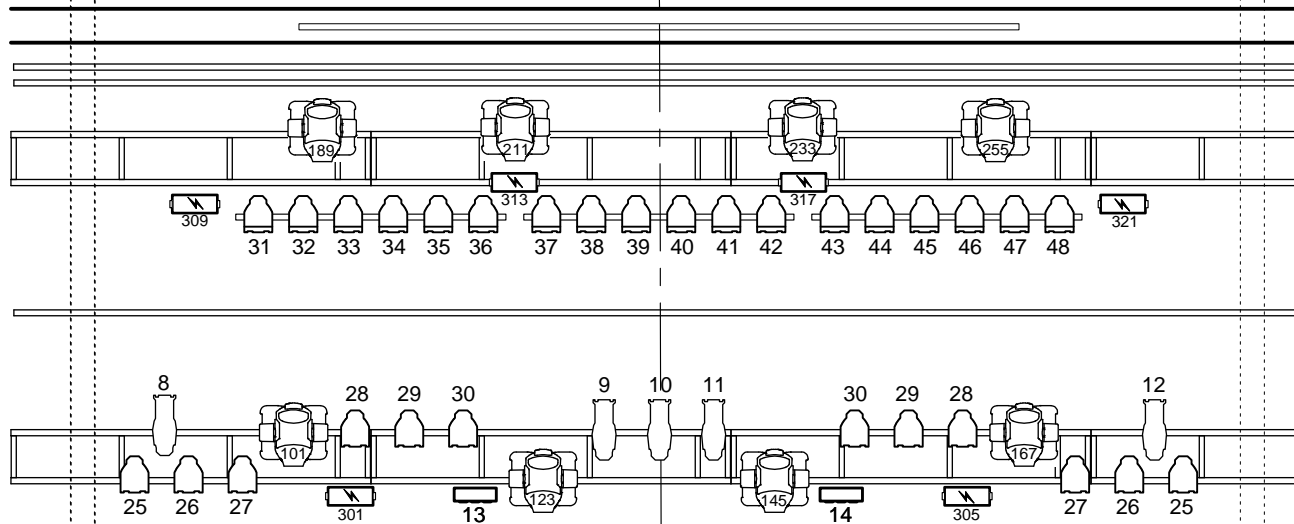

400A Lighting Disconnect

100A Sound Disconnect

Full Stage Blackout  
 15x20 Projection Screen Dead Hung 5'6 off Floor  
 Full Stage Travel Blackout  
 2x **US Winch Pipes** 150# Max Load  
 32' Long 23'0" Max Trim

**US Truss** 22'-6" Max Trim  
 23'-0" to DS Edge  
 7'-6" to US Wall  
 4- VL2500  
 4- Atomic 3000  
 3- 6lamp NSP PAR Bars  
 2- Spare 208v 20A L6-20

**MS Winch Pipe**  
 32' Long, 150# Max Load  
 23'0" Max Trim, 11'0" to US Wall

**MS Truss** 22'-6" Max Trim  
 16'-0" to DS Edge  
 15'-0" to US Wall  
 4- VL2500  
 2- Atomic 3000  
 2- 3lamp DWE Blinders  
 12- PAR MFL  
 5- 36" Leko  
 3- Spare 120v 20A L5-20

**Power:**

**Lighting:**  
 400Amp 3ph 5wire cam-lock both non-, and reversed G&N. at dimmer mezzanine SR.  
**25' Feeder Required to reach stage floor.**

**Sound:**  
 100Amp 3ph 5wire cam-lock non-reversed G&N at stage level SR.

100Amp Sound Sub Panel on back wall SR corner.  
 4- 120v 20A Edison  
 2- 120/208v 30A L14-30  
 1- 208v 20A L6-20

**FOH Followspots:**

2x Lycian M2 Med throw 2.5k HMI at rear balcony (98' throw, 25° vertical angle)  
**House Spot color:**  
 1-L204 Full CTO  
 2-L205 Half CTO  
 3-R34 Pink  
 4-L180 Lav  
 5- L106 Red

**FOH Lighting Control:**

1- RoadHog w/ 2 miniwings  
 1- Backup HogPC

**FOH Snake:**

5- 5pin DMX (1 needed for house rig)  
 2- 3pin XLR com lines  
 3- 20A Edison circuits

**Notes:**

-All symbols and positions not to scale.  
 -All House Truss 36' length.  
 -Overstage Structural I-beams run US/DS 16' to CTR  
 -All Truss power & DMX run to backstage SR.  
 -All PARs on bars are hardwired to bar.  
 -Venue has 2 LeMaitre Radiance Hazers SL & SR.  
 -Hazers and House Lights controlled via FOH DMX.  
 -Full stock of most commonly used color available.  
 -All 120v circuits are L5-20  
 -All 208v circuits are L6-20

**KEY**

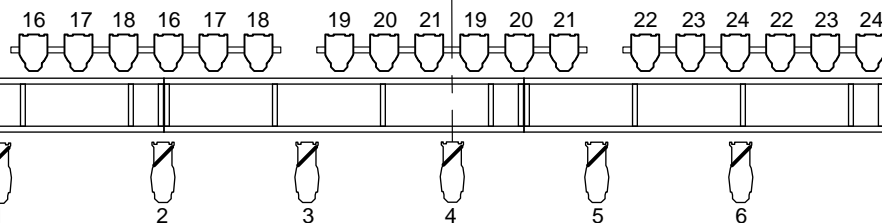
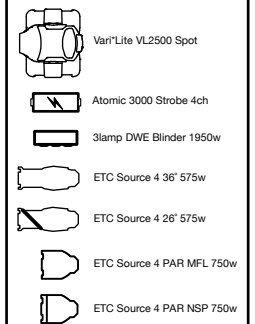

**DS Truss** 29'-0" Max Trim

9'-6" to DS Edge  
 41'-0" to US Wall  
 3- 6lamp MFL PAR Bars  
 7- 26" Lekos  
 1- Spare DMX to backstage SR  
 1- RGBHV BNC to backstage SR  
 1- Spare 6cir SOCA to backstage SR  
 3- Spare 120v 20A L5-20

**DMX Patch:**

001-048- 48x2.4k StrandRack Dimmers  
 049-060- Houselight Dimmers  
 061-062- Hazer (061-Haze, 062-Fan)  
 063-100- Open  
 101-276- VL2500 Spots  
 277-300- Open  
 301-324- Atomic 3000 Strobes  
 325-512- Open

**House Light Plot**

Date: 3/3/2010 Scale: 3/16"=1'0"  
 Drawn: AJK Plate 1/1



1300 Van Ness Ave  
 San Francisco, CA 94109

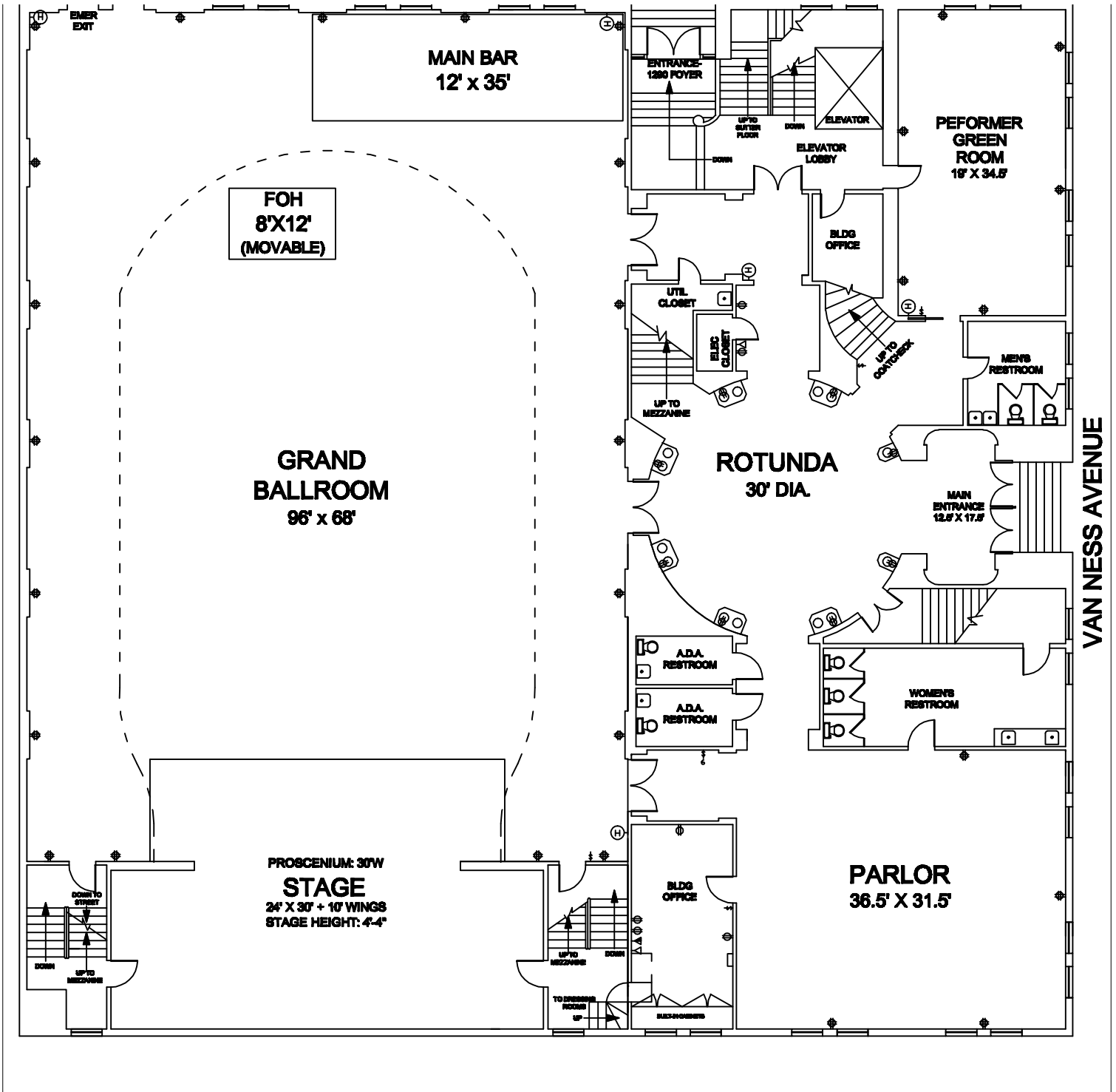

**LEGEND**

- ⊙ 110V-UNIPLEX OUTLET
- ⊕ 110V-DUPLEX OUTLET
- ⊞ 110V-QUADPLEX OUTLET
- ⊙(220) 220V- UNIPLEX OUTLET
- △ TELEPHONE PORT
- ▲ DATA COMM PORT
- ⌘ ELECTRICAL SWITCH
- ⊙(H) FIRE EXTINGUISHER

<i>CLIENT</i>	REGENCY CENTER
<i>PROJECT NAME</i>	REGENCY BALLROOM
<i>DESCRIPTION</i>	GENERAL LAYOUT
<i>DATE</i>	6/20/1

## DIRECTIONS TO THE REGENCY BALLROOM

From Highway 101 North / South

### **From US-101 N**

1. Take exit 434A to merge onto Mission St/US-101
2. Turn left at US-101/S Van Ness Ave
3. Go 1 mile
4. Venue main entrance/load in on right at 1300 Van Ness Ave (at Sutter), San Francisco, CA 94109

### **From US-101 S**

1. Cross Golden Gate Bridge
2. Stay to left after Toll Plaza to continue on 101
3. Curve right to exit toward Lombard St
4. Stay on Lombard
5. Right on Van Ness to continue on 101
6. Left on Bush St
7. Right on Polk St
8. Right on Sutter St
9. Right on Van Ness Ave
10. Venue main entrance / load in on right at 1300 Van Ness Ave

# REGENCY BALLROOM RESERVED PARKING

Any parking requirements beyond these spaces not guaranteed by venue.

All parking tickets including curbed wheels and street sweeping are responsibility of drivers/clients/tours.



1. Fern St between Van Ness & Sutter, first 4 spots from corner of Van Ness.
  - Fits 1 bus w/trailer OR 1 truck OR 2 buses no trailer OR equivalent.
  - Shore power available and must be used immediately upon parking in, no generators.
2. Sutter St between Polk & Van Ness, last 2 spots on left side.
  - Fits 1 bus no trailer OR 1 van w/trailer OR 2 cars OR equivalent.
3. Van Ness between Hemlock & Polk, 4 spots not including blue zone.
  - Fits 1 truck OR 1 bus w/trailer OR equivalent.



## **PARKING RESTRICTIONS**

### **SUTTER ST. (North side)**

No parking between 4-6pm, Mon-Fri -- TOW AWAY

No parking 7-8am Wednesday for street sweeping.\*

### **SUTTER ST. (South side)**

No parking 7-8am Friday for street sweeping.\*

### **VAN NESS (1200 block, old Galaxy Theater)**

No parking 2am-6am every day including holidays, street sweeping.\*

Do not block blue zone.

### **VAN NESS (1300 block, in front of our building)**

No parking, loading/unloading only in white zone

Rest of block is bus zone, \$1500 fine for obstruction

### **FERN ALLEY**

No parking 2am-6am Tues, Thurs, Sat for street sweeping.\*

Map of area:

<http://tinyurl.com/regencymap>

\* Note that street sweeping restrictions override ALL parking permits.

Please remember to CURB YOUR WHEELS on Sutter and Fern or you will be cited.